

NEW! UPGRADED 4.0 AMP VERSION

CMSH3-20L
CMSH3-40L

SURFACE MOUNT
LOW FORWARD VOLTAGE
SILICON SCHOTTKY
BARRIER RECTIFIER
4.0 AMP, 20 AND 40 VOLTS

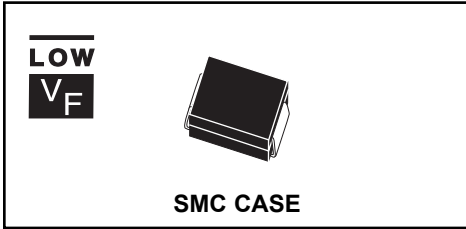

CentralTM

Semiconductor Corp.

FEATURES:

- New Upgraded 4.0 Amp Average Forward Current (Upgraded from 3.0 Amps)
- Low Forward Voltage Drop
- Flammability Classification UL94V-0
- High Current Capability
- Superior Lot To Lot Consistency
- Low Cost
- "C" Bend Construction Provides Strain Relief when mounted on a PC Board
- High Reliability

DESCRIPTION:

The CENTRAL SEMICONDUCTOR 4.0 Amp Surface Mount Low V_F Silicon Schottky Rectifier is a high quality, well constructed, highly reliable component designed for use in all types of commercial, industrial, entertainment, computer, and automotive applications where high efficiency is required. To order devices on 12mm Tape and Reel (3000/13" Reel), add TR13 suffix to part number.

MARKING CODES:

CMSH3-20L: CS320L

CMSH3-40L: CS340L

MAXIMUM RATINGS: ($T_A=25^\circ\text{C}$ unless otherwise noted)

	SYMBOL	CMSH3-20L	CMSH3-40L	UNITS
Peak Repetitive Reverse Voltage	V_{RRM}	20	40	V
DC Blocking Voltage	V_R	20	40	V
RMS Reverse Voltage	$V_{R(RMS)}$	14	28	V
* Average Forward Current ($T_L=90^\circ\text{C}$)	I_O	4.0		A
* Peak Forward Surge Current (8.3ms)	I_{FSM}	150		A
Operating and Storage				
Junction Temperature	T_J, T_{stg}	-65 to +150		$^\circ\text{C}$
Thermal Resistance	θ_{JL}	14		$^\circ\text{C/W}$

ELECTRICAL CHARACTERISTICS: ($T_A=25^\circ\text{C}$ unless otherwise noted)

SYMBOL	TEST CONDITIONS	MIN	TYP	MAX	UNITS
I_R	$V_R=Rated$ V_{RRM}			0.50	mA
I_R	$V_R=Rated$ $V_{RRM}, T_A=100^\circ\text{C}$			35	mA
* V_F	$I_F=4.0A$ (CMSH3-20L)			0.42	V
* V_F	$I_F=4.0A$ (CMSH3-40L)			0.44	V
V_F	$I_F=3.0A$ (CMSH3-20L)			0.38	V
V_F	$I_F=3.0A$ (CMSH3-40L)			0.40	V

* Upgraded Specification

R2 (26-August 2003)

SMC CASE - MECHANICAL OUTLINE

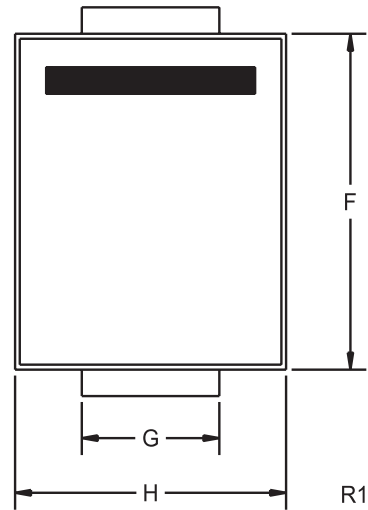
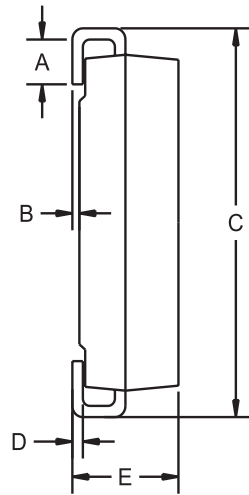

DEVICE	MARKING CODE
CMSH3-20L	CS320L
CMSH3-40L	CS340L

SYMBOL	INCHES		MILLIMETERS	
	MIN	MAX	MIN	MAX
A	0.030	0.060	0.76	1.52
B	0.004	0.008	0.10	0.20
C	0.305	0.320	7.75	8.13
D	0.006	0.012	0.15	0.31
E	0.079	0.103	2.00	2.62
F	0.260	0.280	6.60	7.11
G	0.108	0.124	2.75	3.15
H	0.220	0.245	5.59	6.22

SMC (REV: R1)